

outdoor

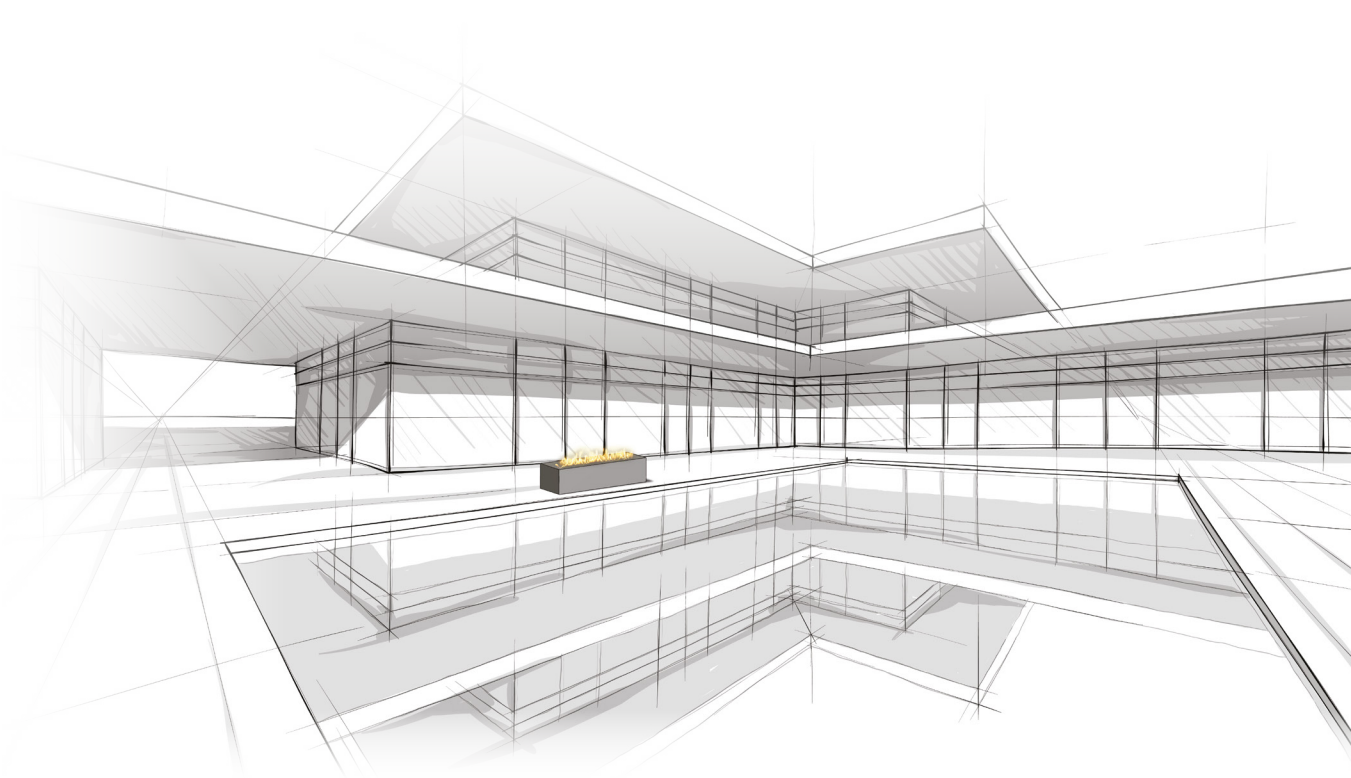

© PLANIKA | Ver. 08062016

www.PLANIKAfires.com

Galio outdoor

GasLineOutdoor

Gas fireplace insert with a linear form

Creates a cozy and unique atmosphere in outdoor living spaces



FEATURES:

- For outdoor use
- Easy installation
- Flame height regulation
- Linear-shape burner
- Propane gas powered
- Safety sensor
- No electrical connection required
- Operational system CE Certified

TECHNICAL DATA:

Net weight: 21 kg / 46 lbs

Heat output Nett: 12,6 kW / 43000 BTU

Gas rate (37 mbar)

min.: 0,54 kg/h; max.: 1,02 kg/h

Finish:

stainless steel



DIMENSIONS:

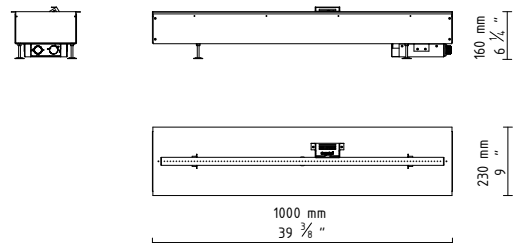

OUTDOOR INSTALLATION REQUIREMENTS:

